



Hartham Road, Isleworth, TW7 5EZ

£245,000

A one bedroom first floor conversion flat situated in this popular residential cul-de-sac location within easy reach of Isleworth and Syon Lane stations, bus routes and shops. The accommodation comprises lounge, kitchen, bathroom and double bedroom. The property benefits from double glazed windows, central heating and is offered for sale with no onward chain. An ideal first time purchase/investment opportunity, call now for more details.

A partner of
The Guild Of Professional Estate Agents
with a network of over 700 independent estate agents

Associated Office: 121 Park Lane, Mayfair, London W1K 7AG t 020 7318 7075

Communal Entrance

Front door, stairs to...

First Floor Landing

Access to loft space, doors to rooms.

Lounge



Front aspect double glazed window, radiator, laminate flooring.

Kitchen



Single drainer stainless steel sink unit with mixer taps and cupboard below, further wall and floor mounted units, built-in hob and oven below, space for washing machine, wall mounted "Main" combi boiler, front aspect double glazed window.

Double Bedroom



Rear aspect double glazed window, radiator, laminate flooring.

Bathroom



White suite comprising panel enclosed bath, pedestal wash hand basin, low level w.c, tiled walls and flooring, rear aspect double glazed window



Flat, Hartham Rd, Isleworth TW7 5EZ

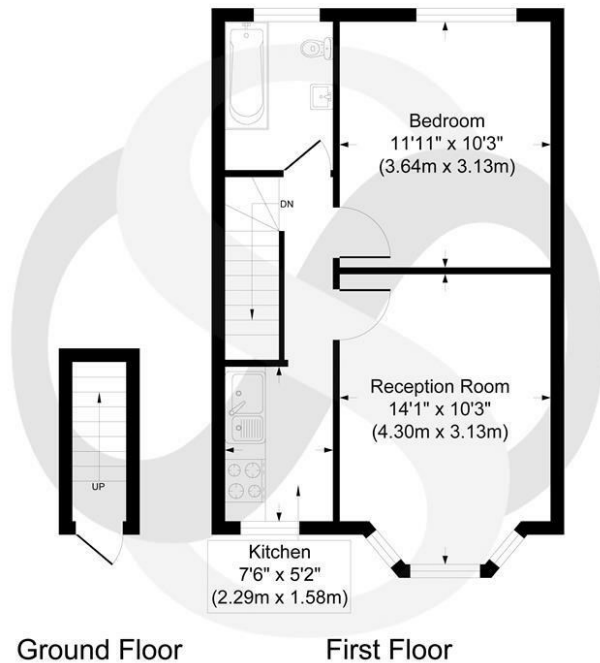

Approx. Gross Internal Floor Area 396 sq. ft / 36.84 sq. m

Illustration for identification purposes only, measurements are approximate, not to scale
Produced by www.truinteriorphoto.com



Energy Efficiency Rating		Current	Potential
Very energy efficient - lower running costs			
(92 plus) A			
(81-91) B			
(69-80) C		73	77
(55-68) D			
(39-54) E			
(21-38) F			
(1-20) G			
Not energy efficient - higher running costs			
England & Wales		EU Directive 2002/91/EC	
Environmental Impact (CO ₂) Rating		Current	Potential
Very environmentally friendly - lower CO ₂ emissions			
(92 plus) A			
(81-91) B			
(69-80) C			
(55-68) D			
(39-54) E			
(21-38) F			
(1-20) G			
Not environmentally friendly - higher CO ₂ emissions			
England & Wales		EU Directive 2002/91/EC	

A partner of

The Guild Of Professional Estate Agents
with a network of over 700 independent estate agents

Associated Office: 121 Park Lane, Mayfair, London W1K 7AG t 020 7318 7075